

# Spring isolator FR-E4-56-( )

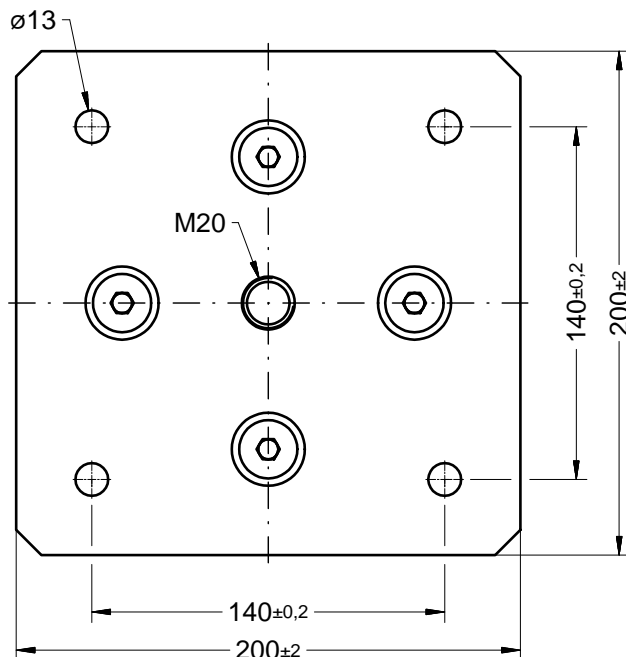

## Applications

- isolation of rotating machines operating above  $600 \text{ min}^{-1}$
- e.g. fans, motors, pumps, compressors, cooling units ...

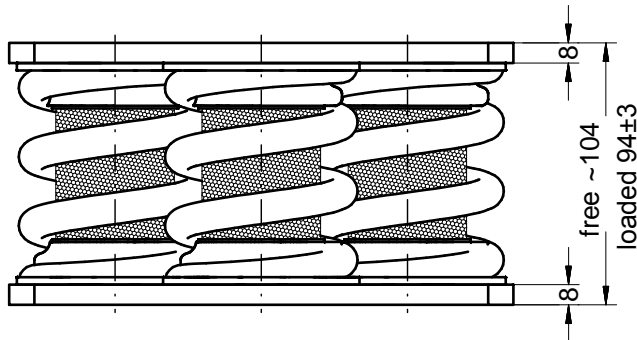

## Description

- top and bottom plate of steel, zinc coated
- springs of spring steel wire, coated black
- damping cushion of stainless steel wire
- scrolls of Al-alloy
- resonant frequency: 5 - 6 Hz
- weight: 7,5 - 9,8 kg according to type
- elastic limit load:  
2 g vertical      0,5 g horizontal

type	load
FR-E4-56- 200	120 - 200 daN
FR-E4-56- 320	200 - 320 daN
FR-E4-56- 520	320 - 520 daN
FR-E4-56- 800	520 - 800 daN
FR-E4-56-1200	800 - 1200 daN
FR-E4-56-1600	1200 - 1600 daN