

Spring isolators FR-E2-34

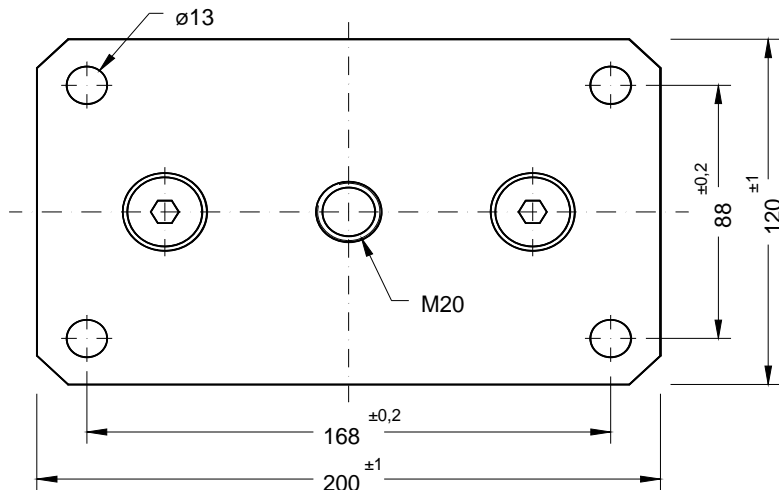

Applications

- Resilient suspension of rotating machines with rotational speed of > 400 rpm , i.e. ventilators, motors, blowers, pumps, air conditioner, test stands, compressors, scales etc.

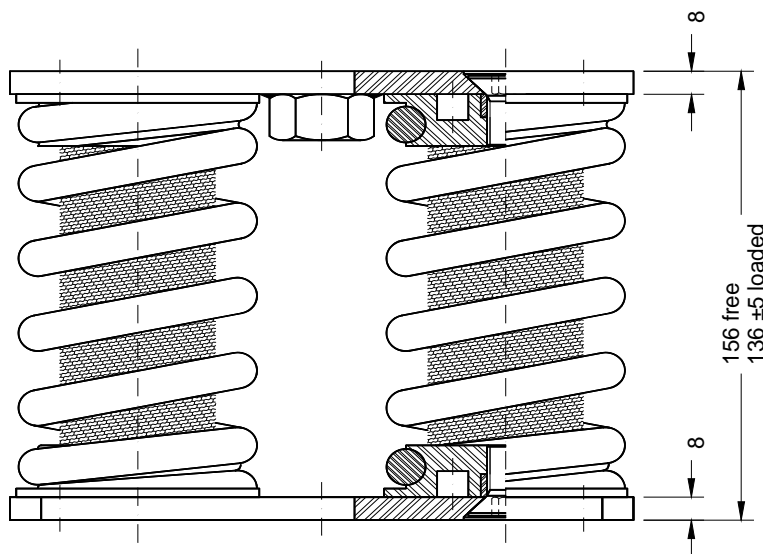

Description

- Steel mounting plates, zinc coated
- Springs made of spring steel wire, black coated
- Damping cushion of stainless steel wire
- Spring end caps of Al-alloy
- Vertical natural frequency: 3 - 4 Hz
- Weight: 4,6 - 6,5 kg depending on type
- Elastic max. load:
1,5 g vertical 0,5 g horizontal

Type	Load
FR-E2-34-200	140 - 200 daN
FR-E2-34-260	180 - 260 daN
FR-E2-34-320	220 - 320 daN
FR-E2-34-460	320 - 460 daN
FR-E2-34-620	440 - 620 daN
FR-E2-34-820	600 - 820 daN